

4' X 4' X 4' I. D. instrument/signal/power manhole

Model no.. EV444

Specifications:

Concrete: 5000 psi @ 28 days, 5-6% air

Reinforcement: #3 rebar @ 6" O.C. both ways in walls, top, and floor
6 1/2" thick walls, 6" thick top and floor

Dayton Swift-Lift pins @ corners

Two Pennsylvania Inserts

PI-1 pulling irons on floor,
centered along sides

Sides and bottom coated with 10 mils of
PPS 922 Superseal water repellant

Weights:

Total: 7950 lbs. Vault: 6430 lbs. Cover 1520 lbs.

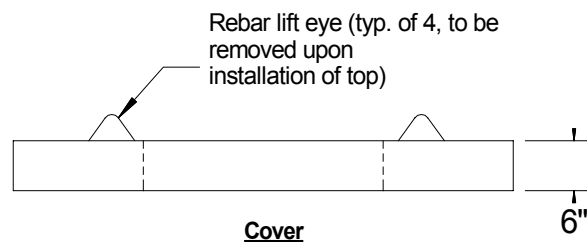

www.concretebuildingsupply.com

Concrete Building Supply Co.

Northeast Concrete Products, Inc.

(P) (518) 563-0700 (F) (518) 563-1392 1024 Military Turnpike,
Plattsburgh, New York 12901

SCALE- 1/2" = 1'

DRAWN BY- R. E. S.